

DETAIL A
IEC 309 32A,
200/346 - 240/415VAC
3L+N+PE PLUG
ENLARGED VIEW

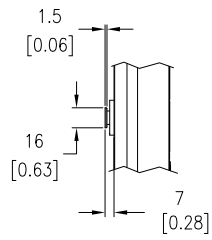

DETAIL B
PEG TOOL LESS MOUNTING
ENLARGED VIEW

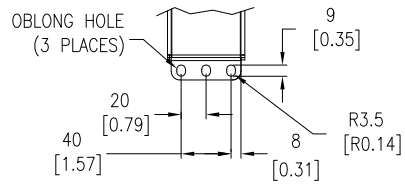

DETAIL C
UNIVERSAL MOUNTING
BRACKET
ENLARGED VIEW

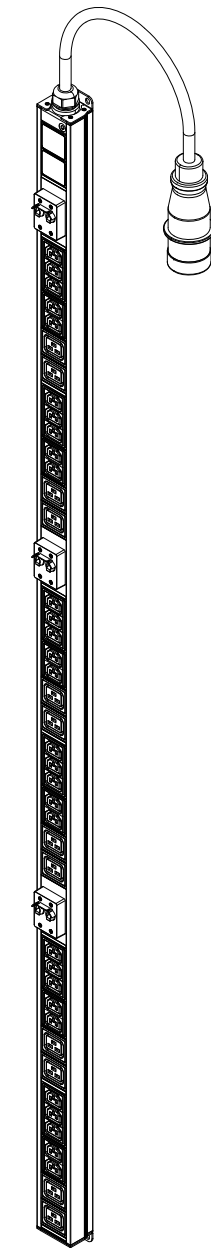

ISOMETRIC VIEW

IEC309, 32A,
200/346 - 240/415VAC
3L+N+PE
INPUT POWER CORD

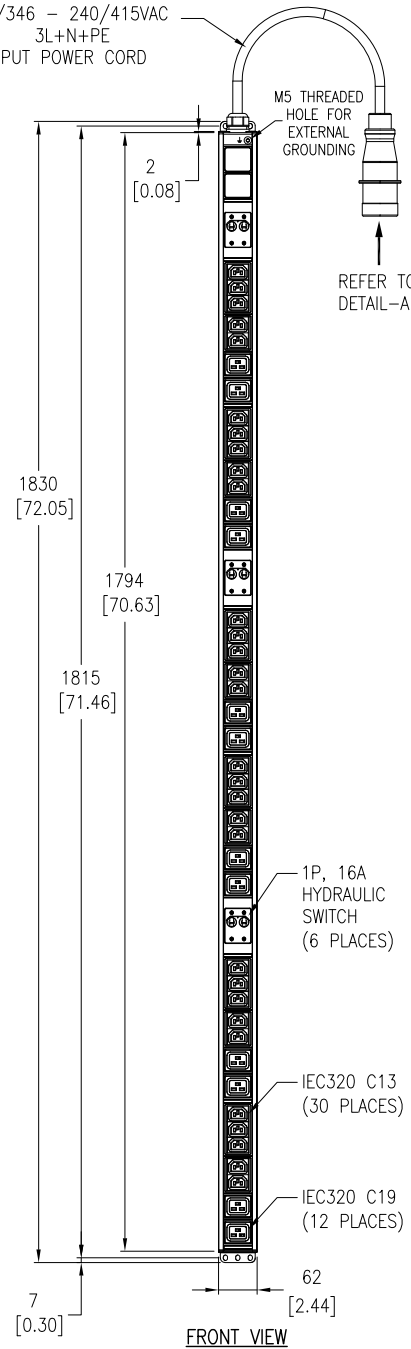

FRONT VIEW

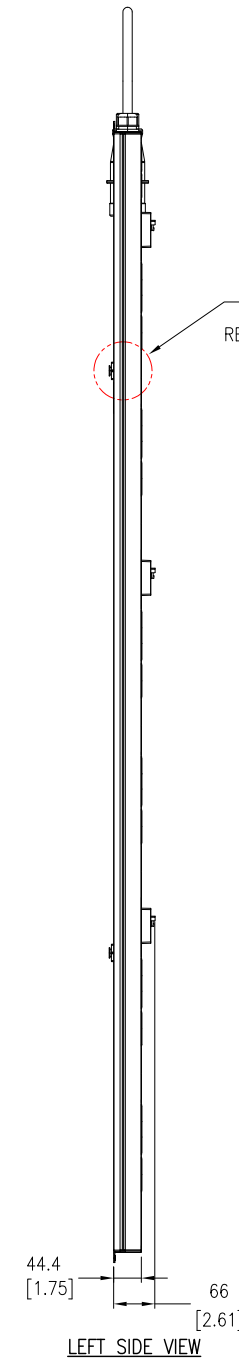

LEFT SIDE VIEW

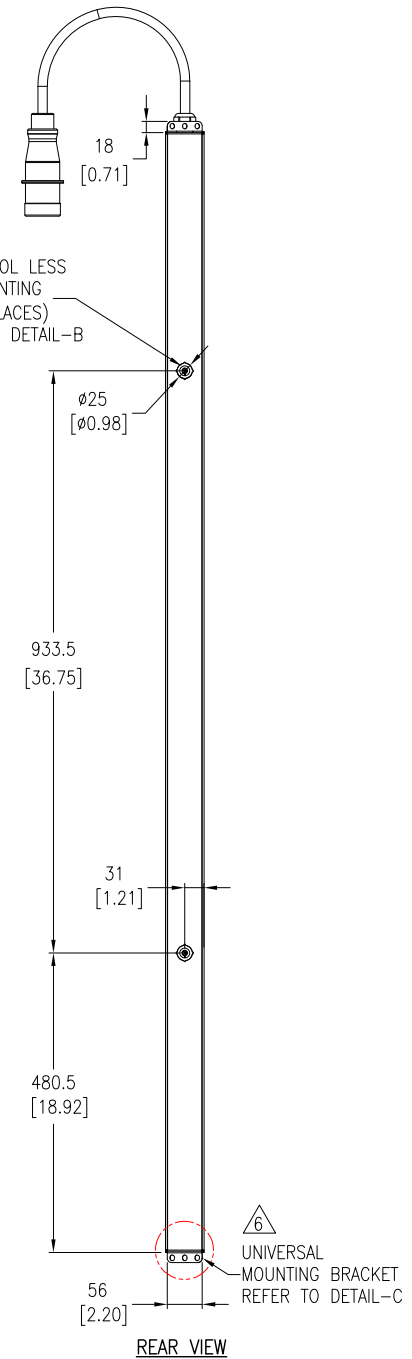

REAR VIEW

NOTES:

1. INSTALLATION SHALL COMPLY WITH ALL APPLICABLE NATIONAL, STATE AND LOCAL ELECTRICAL CODES.
2. REFER TO PRODUCT DOCUMENTATION FOR ADDITIONAL DETAILS PRIOR TO INSTALLATION AND PREPARATION WORK.
3. UNLESS OTHERWISE SPECIFIED, ALL DIMENSIONS ARE IN MILLIMETERS [INCHES].
4. NET WEIGHT OF UNIT IS 5.14kg [11.33 lb].
5. LENGTH OF THE CORD IS 2000mm [78.5 inches].
- △ 6. UNIVERSAL MOUNTING BRACKET IS AN ALTERNATIVE MOUNTING METHOD TO THE TOOL LESS MOUNT FOR 3RD PARTY ENCLOSURES. BRACKET IS PROVIDED WITH THE UNIT.
7. REFER TO WARNING LABEL ON REAR OF UNIT FOR SCREW MOUNTING.

THIS DRAWING AND SPECIFICATIONS HEREIN ARE THE PROPERTY OF SCHNEIDER ELECTRIC AND SHALL NOT BE COPIED, REPRODUCED OR USED IN WHOLE OR IN PART, AS THE BASIS FOR THE MANUFACTURE OR SALE OF ITEMS WITHOUT WRITTEN PERMISSION FROM SCHNEIDER ELECTRIC. THIS DRAWING IS BASED UPON LATEST AVAILABLE INFORMATION AND IS SUBJECT TO CHANGE WITHOUT NOTICE.



TITLE: Easy PDU, Basic ZERO U, 22kW, 230V
INPUT: IEC309, 3L+N+PE
OUTPUT: (30) IEC320 C13 & (12) IEC320 C19
GENERAL ARRANGEMENT
PROJECT: SUBMITTAL DRAWING SHEET 1 OF 2

DWG NO: EPDU1232B REV. 3
DRAWN: JAYAPRAKASH/DIBYA 02-FEB-22 FIRST ANGLE PROJECTION
ENGINEER: Troy LIU 02-FEB-22
APPROVED: Tong XU 02-FEB-22

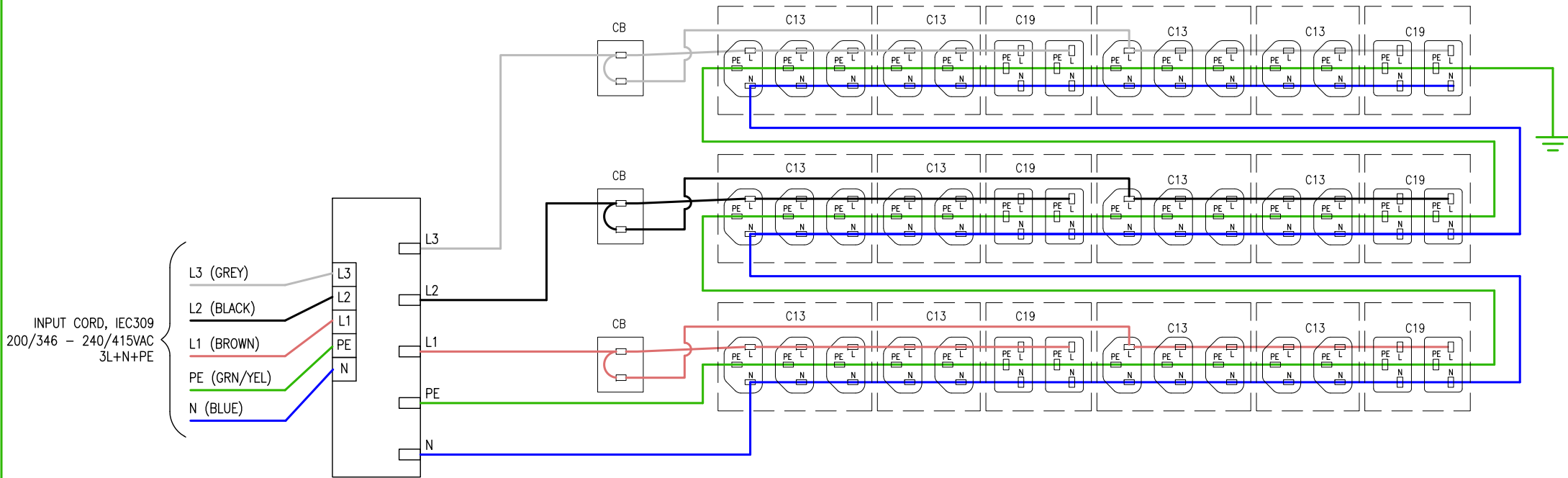

INPUT CORD, IEC309
200/346 - 240/415VAC
3L+N+PE

- L3 (GREY)
- L2 (BLACK)
- L1 (BROWN)
- PE (GRN/YEL)
- N (BLUE)

NOTES:

1. INSTALLATION SHALL COMPLY WITH ALL APPLICABLE NATIONAL, STATE AND LOCAL ELECTRICAL CODES.
2. REFER TO PRODUCT DOCUMENTATION FOR ADDITIONAL DETAILS PRIOR TO INSTALLATION AND PREPARATION WORK.
3. THIS DRAWING DEPICTS THE POWER SYSTEM CONNECTIONS AND IS NOT REPRESENTATIVE OF THE PHYSICAL LAYOUT. PLEASE REFER TO MECHANICAL DRAWINGS FOR PHYSICAL LAYOUT.

THIS DRAWING AND SPECIFICATIONS HEREIN ARE THE PROPERTY OF SCHNEIDER ELECTRIC AND SHALL NOT BE COPIED, REPRODUCED OR USED IN WHOLE OR IN PART, AS THE BASIS FOR THE MANUFACTURE OR SALE OF ITEMS WITHOUT WRITTEN PERMISSION FROM SCHNEIDER ELECTRIC. THIS DRAWING IS BASED UPON LATEST AVAILABLE INFORMATION AND IS SUBJECT TO CHANGE WITHOUT NOTICE.



TITLE: Easy PDU, Basic
ZERO U, 22kW, 230V
INPUT: IEC309, 3L+N+PE
OUTPUT: (30) IEC320 C13 & (12) IEC320 C19
SCHEMATIC DIAGRAM

DWG NO: EPDU1232B

REV. 3

PROJECT: SUBMITTAL DRAWING SHEET 2 OF 2

DRAWN: JAYAPRAKASH/DIBYA	02-FEB-22
ENGINEER: Troy LIU	02-FEB-22
APPROVED: Tong XU	02-FEB-22

ANGLE PROJECTION
N.A.